



409 CHESTER AVENUE HOLDING  
CO LLC  
409 CHESTER AVE  
ANNAPOLIS, MD, 21403

APPLICANT:  
SHM ANNAPOLIS LLC  
423 CHESTER AVE  
ANNAPOLIS, MD, 21403  
LOT N/A, TM 52D  
GRID 16, PARCEL 814

CITY OF ANNAPOLIS  
6TH STREET  
ANNAPOLIS, MD, 21403

Tax Account No.:  
6000-0540-1974  
Tax Map: 52D  
Parcel: 814  
Deed Ref: 36778/00262  
Lot: N/A  
Zoning: WME  
Lot Size: 3.54 AC

PROPOSED HARBOR LINE  
AMENDMENT  
SCALE: 1" = 100'  
Waterfront Engineering,  
Design and Construction, Inc.  
8348 Ritchie Hwy.  
Pasadena, MD 21122  
(410) 798-1494  
waterfrontdesign@verizon.net

PROPOSED:  
Marina Reconstruction  
in: Back Creek  
co: Anne Arundel  
Application by: SHM Annapolis LLC  
Sheet 1 of 2 Date: April, 2025

LON: -76.48127°  
LAT: 38.96693°

State: Maryland  
at: Eastport

NOTE: All dimensions and measurements shall be field verified by contractor.

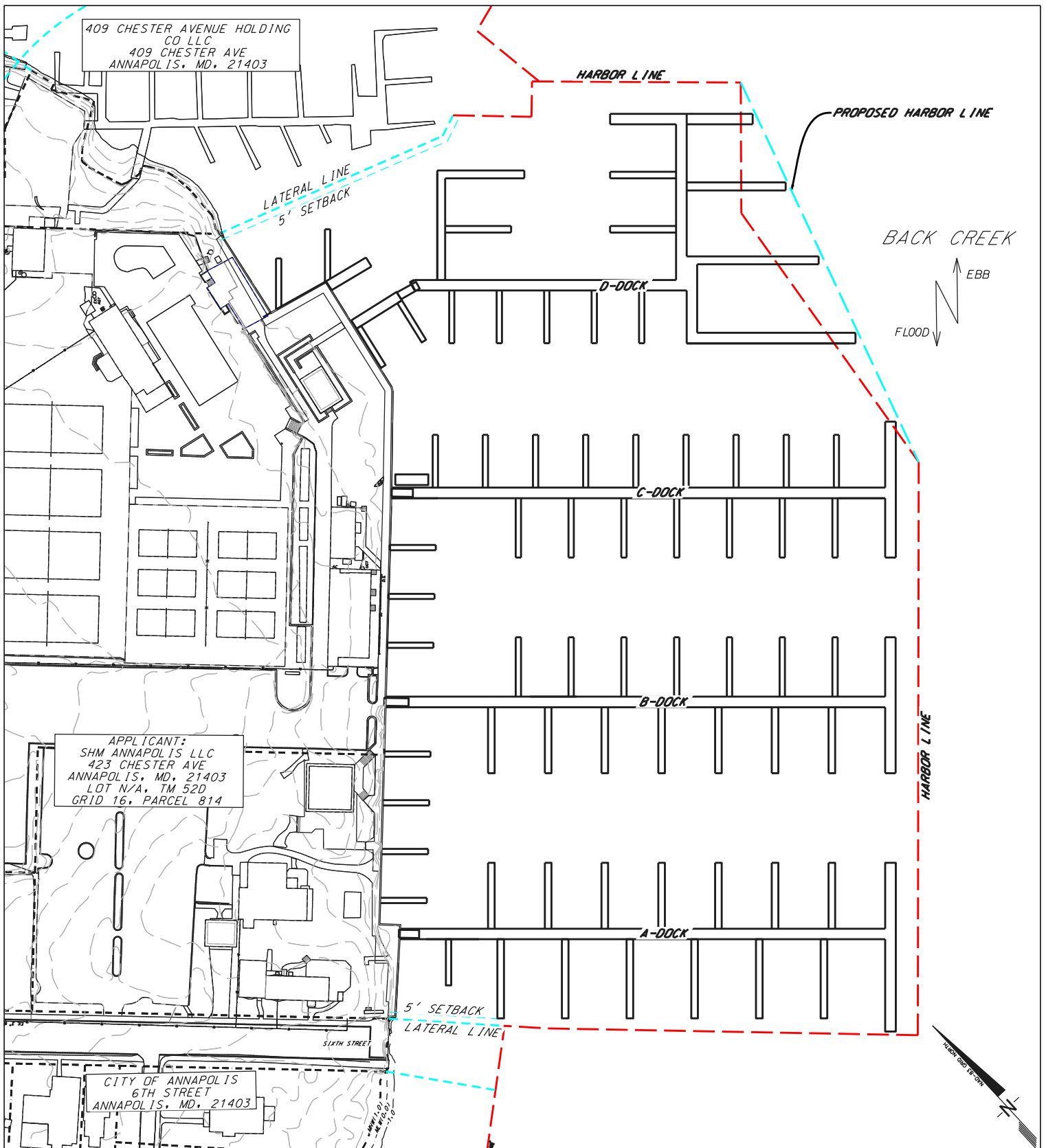

<p>Tax Account No.: 6000-0540-1974 Tax Map: 52D Parcel: 814 Deed Ref: 36778/00262 Lot: N/A Zoning: WME Lot Size: 3.54 AC</p>	<p>PROPOSED HARBOR LINE W/ PROPOSED PIERS SCALE: 1" = 100'</p> <p>Waterfront Engineering, Design and Construction, Inc. 8348 Ritchie Hwy. Pasadena, MD 21122 (410) 798-1494 waterfrontdesign@verizon.net</p>	<p>PROPOSED: Marina Reconstruction</p> <p>in: Back Creek co: Anne Arundel Application by: SHM Annapolis LLC Sheet 2 of 2 Date: April 1, 2025</p> <p>LON: -76.48127° LAT: 38.96693°</p> <p>State: Maryland at: Eastport</p>
--	--	--

NOTE: All dimensions and measurements shall be field verified by contractor.