

Ordinance O-41-15

**A Comprehensive
Zoning District
Map Amendment
And Technical
Update
ZTA2015-001**

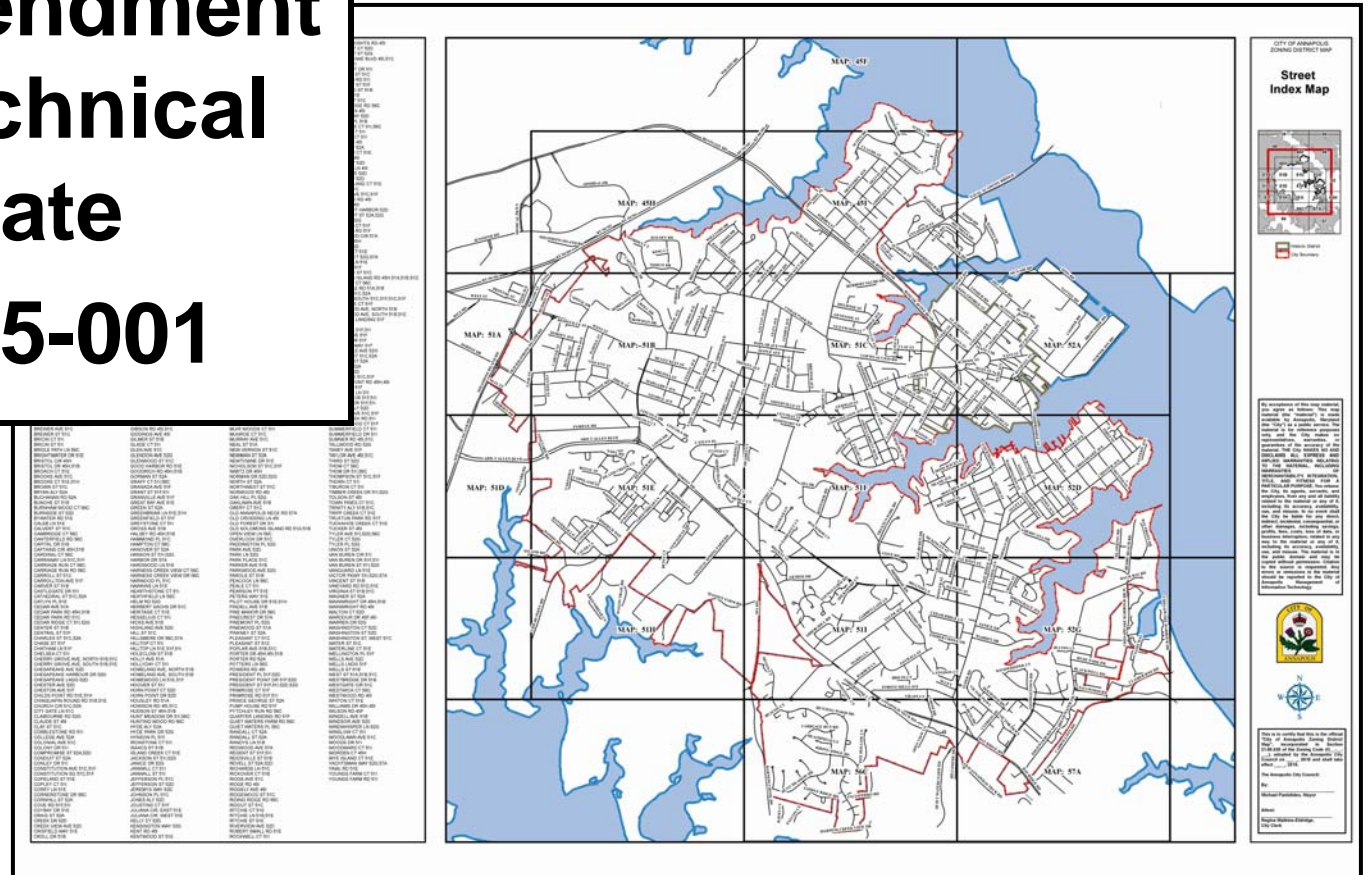

- **New State Department of Assessment and Taxation (SDAT) Tax Map Grid:** SDAT produced a new parcel mapping grid in 2009. This puts the city in a square grid system
- **Changes to the mapped parcel boundaries and overall improvements in mapping accuracy:** As technology develops and data collections improve, digital mapping is increasing in accuracy.
- **Correcting oversights made during JMT's mapping process**
- **General updates:** Zoning map amendments passed by City Council since 2004 (not included in the official 2005 zoning maps) are:
 - AIC Forest, LLC Property Annexation (R-19-04 Amended)
 - Bowen Property Annexation (R-23-04 Revised)
 - Lonergan Bus Company Property Rezoning (O-31-04)
 - 1244 and 1248 Tyler Ave Rezoning (O-38-04)
 - The Mixed Use Height Districts (O-11-05)
 - Rodgers Property Zoning (O-13-05)
 - Katherine Property Zoning (O-16-05)
 - The Eastport Gateway Overlay District (O-30-05)
 - Annapolis Neck Zoning (O-38-05)
 - Hyatt Property at Marda Ln. and Forest Dr. (O-23-06)
 - 1321 Forest Drive/Lowry's Site (O-18-09)
 - 214 Duke of Gloucester (O-67-09)

First category of changes: Less than 5-foot shift in the mapped zoning line

In this category, the increased mapping accuracy now possible with digital GIS mapping technology revealed discrepancies between parcel lines and mapped zoning lines. If there was less than 5' of difference between a parcel line and a zoning line and otherwise a general match, the zoning line was shifted over to line up precisely with the parcel line. These changes are not visible to the naked eye on the paper maps when printed at the 200-foot scale level.

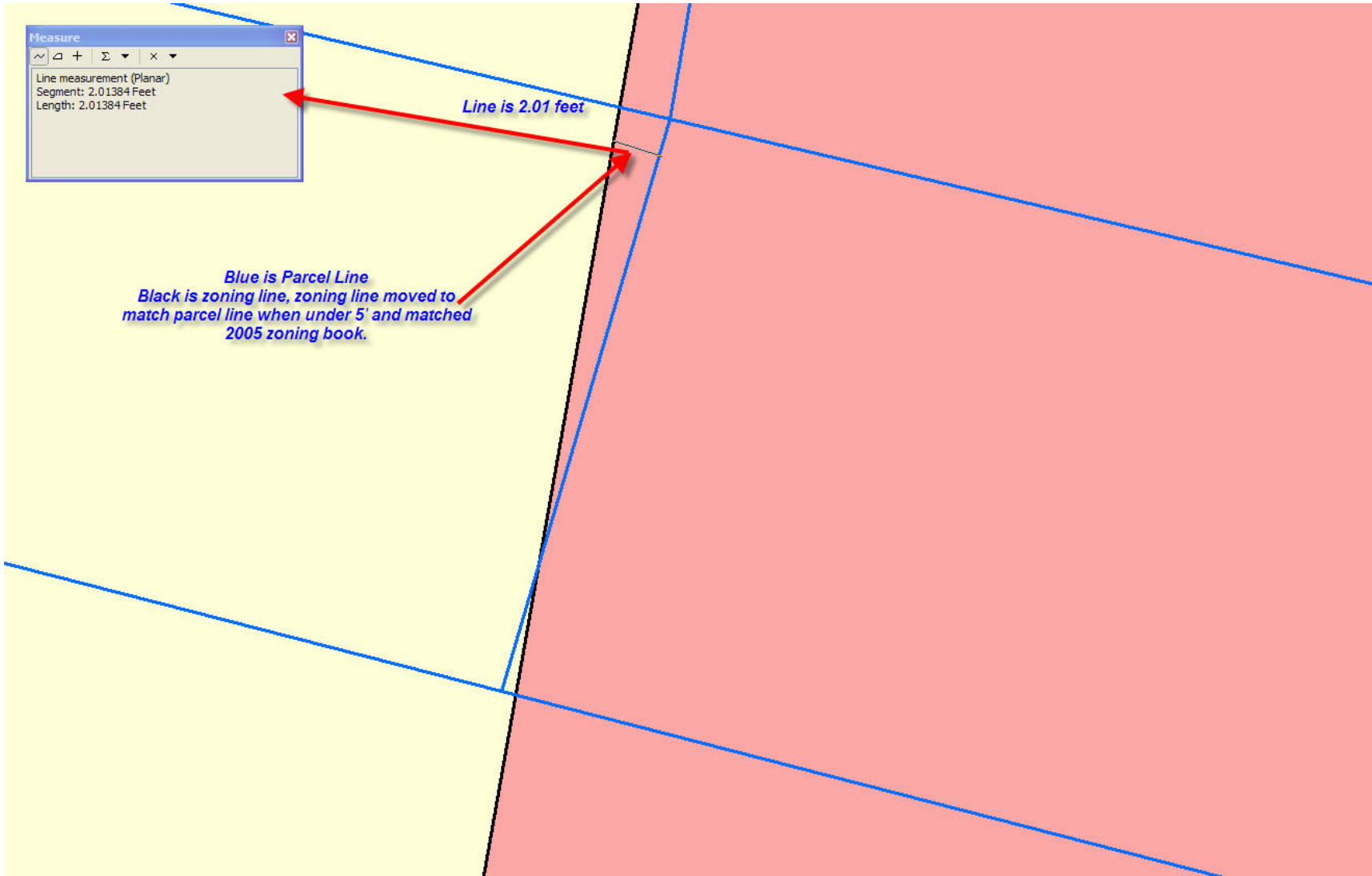

Second category of changes: Zoning line corrections greater than 5 feet, corroborated with prior ordinances or tax maps

Any adjustment in line location greater than 5 feet is shown on the attached map (Appendix A) and listed individually in the attached table (Appendix B), with a reference to the ordinance and/or prior tax map that showed the correct boundary.

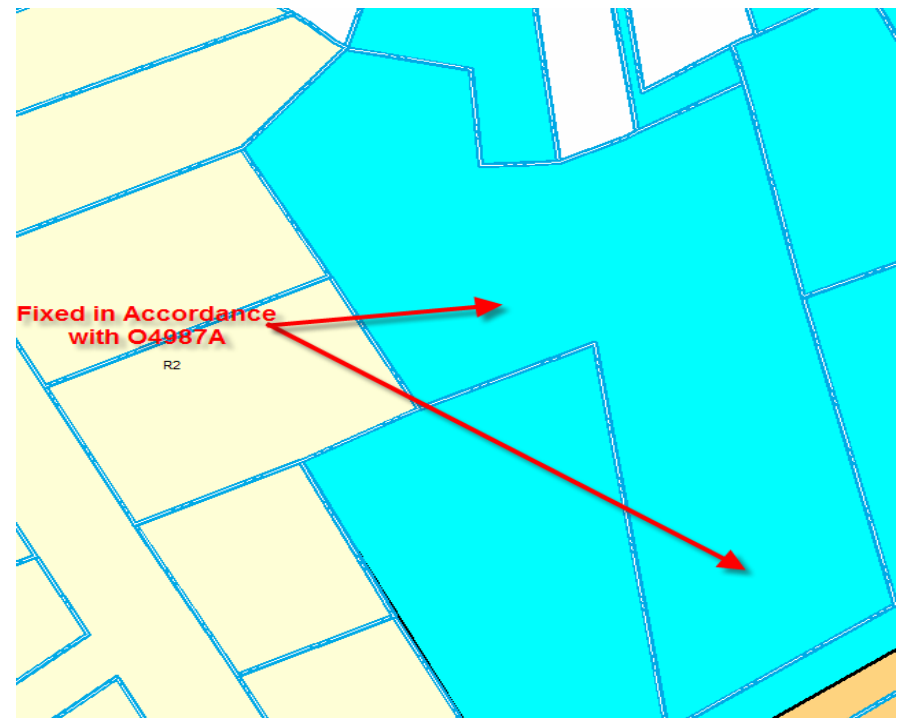
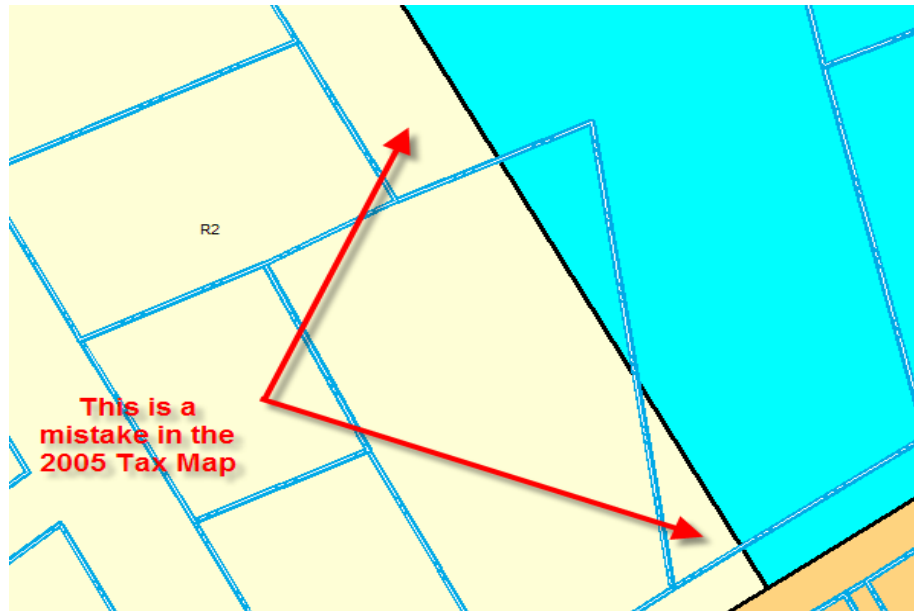

2005

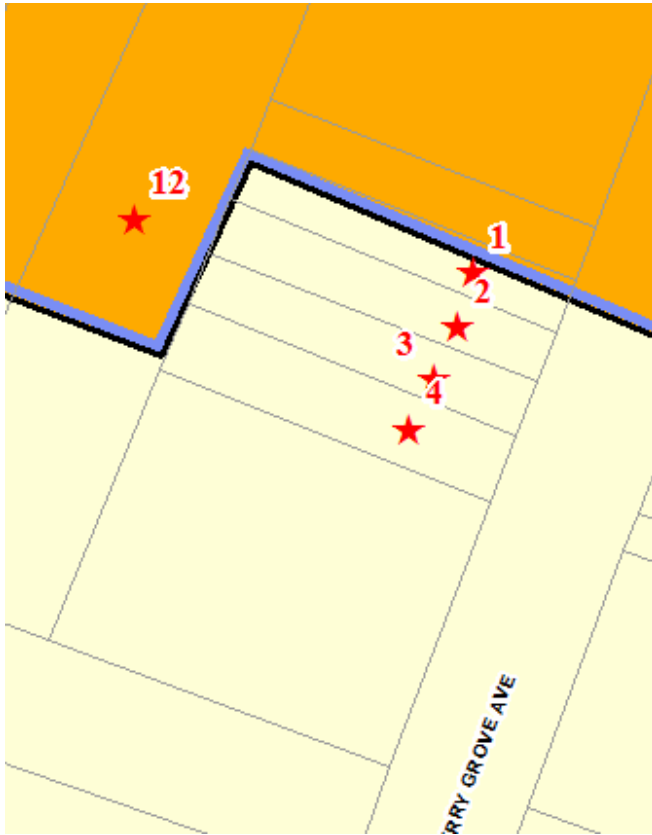

2015

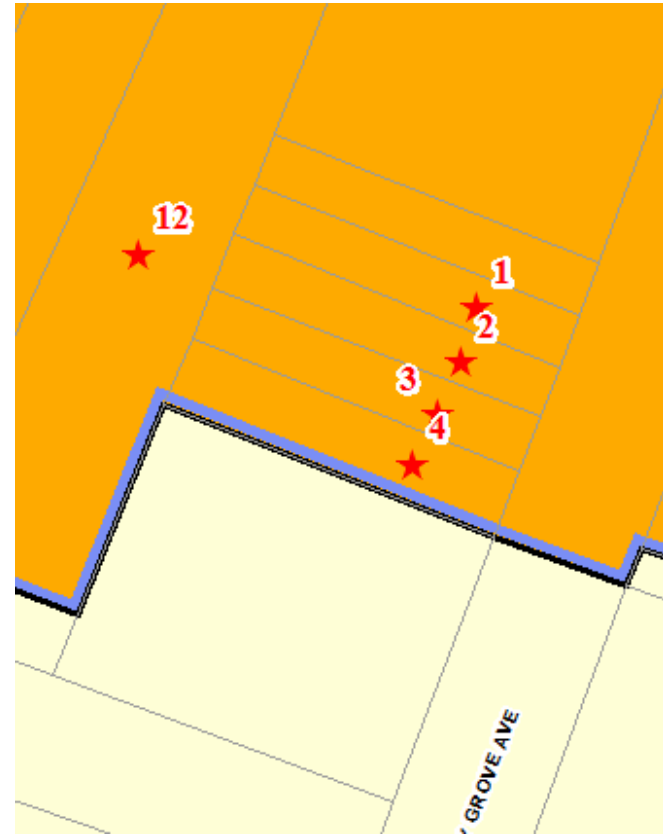

#	Map #	Area Title	Ordinance/ Reference	
	Parcel ID	Change		
	Address		Old	New
	51B	Outer West St Area		
1	020600090059195	An error was made while digitizing documents for the 2005 Zoning Maps –	0-43-88A	
	8 S. Cherry Grove Ave	This parcel is now correctly zoned as all R3-NC.	Split w/ R2	All R3-NC
2	020600090059194	An error was made while digitizing documents for the 2005 Zoning Maps –	0-43-88A	
	10 S. Cherry Grove Ave	This parcel is now correctly zoned as all R3-NC.	R2	R3-NC
3	020600090059193	An error was made while digitizing documents for the 2005 Zoning Maps –	0-43-88A	
	12 S. Cherry Grove Ave	This parcel is now correctly zoned as all R3-NC.	R2	R3-NC
4	020600090059192	An error was made while digitizing documents for the 2005 Zoning Maps –	0-43-88A	
	14 S. Cherry Grove Ave	This parcel is now correctly zoned as all R3-NC.	R2	R3-NC
5	020667590012349	An error was made while digitizing documents for the 2005 Zoning Maps –	O-43-88A	
	3 N. Homeland Ave.	The parcel is now correctly zoned as all R2.	10% split w/ R3	All R2
6	020667500835800	An error was made while digitizing documents for the 2005 Zoning Maps –	0-43-88A	
	8 N. Homeland Ave.	This parcel is now correctly zoned as all R2.	20% split w/ R3-NC	All R2
7	020667501111600	An error was made while digitizing documents for the 2005 Zoning Maps –	0-43-88A	
	3 N. Southwood Ave.	This parcel is now correctly zoned as all R2 and now has the correct address (#3 and #5 were reversed).	20% split w/ R3-NC	All R2
8	020600008035800	An error was made while digitizing documents for the 2005 Zoning Maps –	0-43-88A	
	1305 West St.	This parcel is now correctly zoned as ALL R3-NC.	25% split w/ R2	All R3-NC
9	020600001062012	An error was made while digitizing documents for the 2005 Zoning Maps –	0-43-88A	
	1309 West St.	This parcel is now correctly zoned as ALL R3-NC.	25% split w/ R2	All R3-NC
10	020600002802500	An error was made while digitizing documents for the 2005 Zoning Maps –	0-43-88A	
	1311 West St.	This parcel is now correctly zoned as ALL R3-NC.	40% split w/ R2	All R3-NC
11	020600002802105	An error was made while digitizing documents for the 2005 Zoning Maps –	O-43-88A	
	1313 West St	This parcel is now correctly zoned as ALL R3-NC.	50% split w/ R2	All R3-NC
12	020600001889000	An error was made while digitizing documents for the 2005 Zoning Maps –	Correct parcel lines and O-43-88A	
	1407 West St.	The parcel line accuracy is now up to date.	50% split w/ R2	90% R3-NC

2005

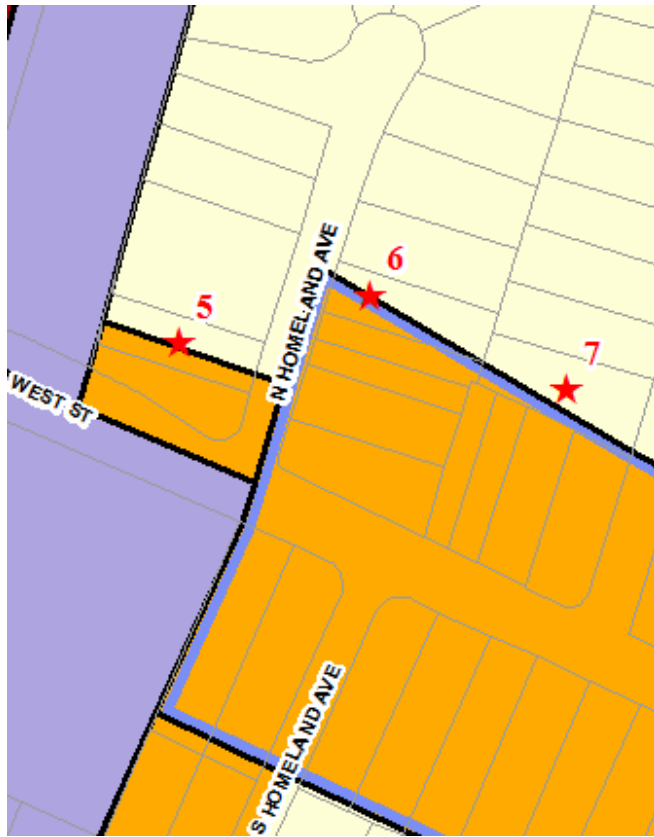

2015

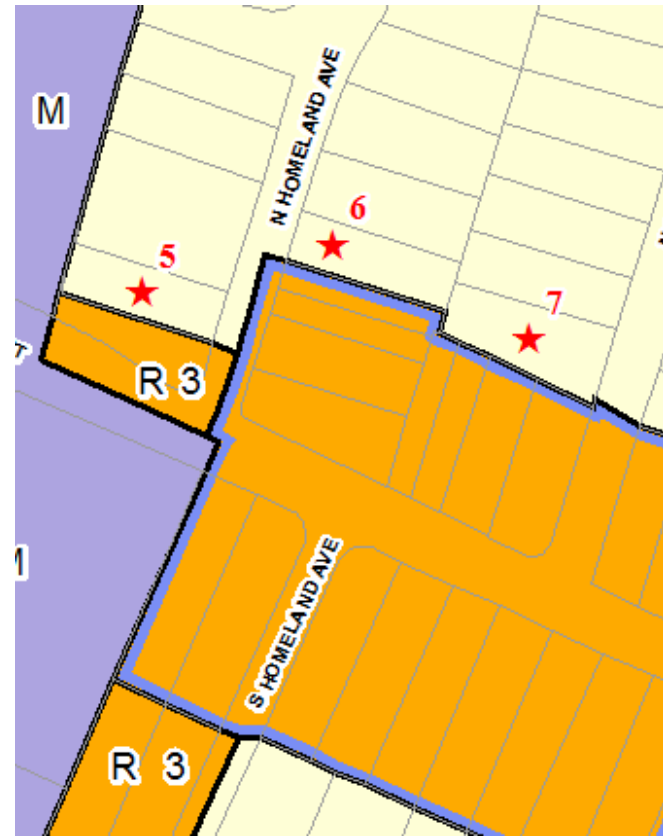

5	020667590012349 3 N. Homeland Ave.	An error was made while digitizing documents for the 2005 Zoning Maps – This parcel is now correctly zoned as all R2.	O-43-88A 10% split w/ R3	All R2
6	020667500835800 8 N. Homeland Ave.	An error was made while digitizing documents for the 2005 Zoning Maps – This parcel is now correctly zoned as all R2.	0-43-88A 20% split w/ R3-NC	All R2
7	020667501111600 3 N. Southwood Ave.	An error was made while digitizing documents for the 2005 Zoning Maps – This parcel is now correctly zoned as all R2 and now has the correct address (#3 and #5 were reversed).	0-43-88A 20% split w/ R3-NC	All R2
8	020667500000000	An error was made while digitizing documents for the 2005 Zoning Maps –	0-43-88A	

2005

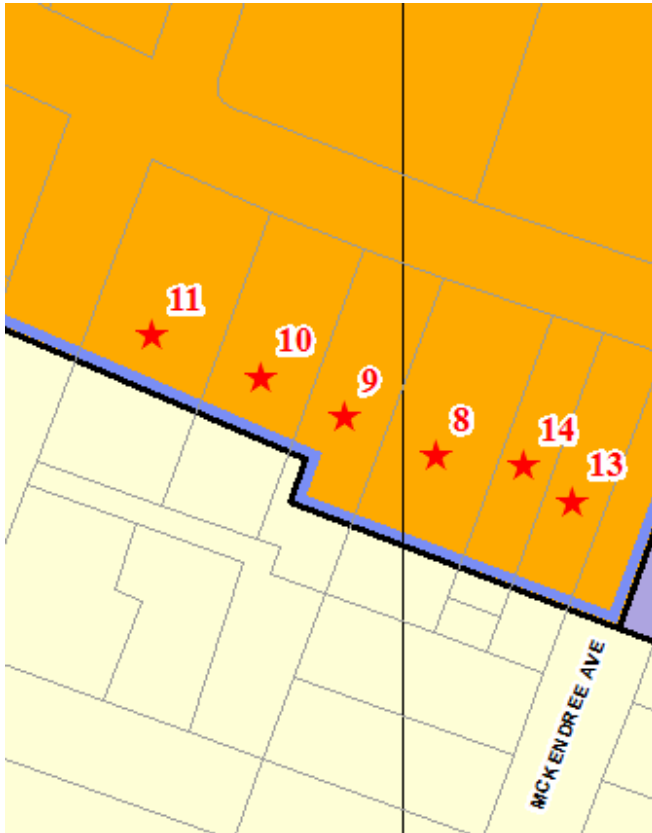

2015

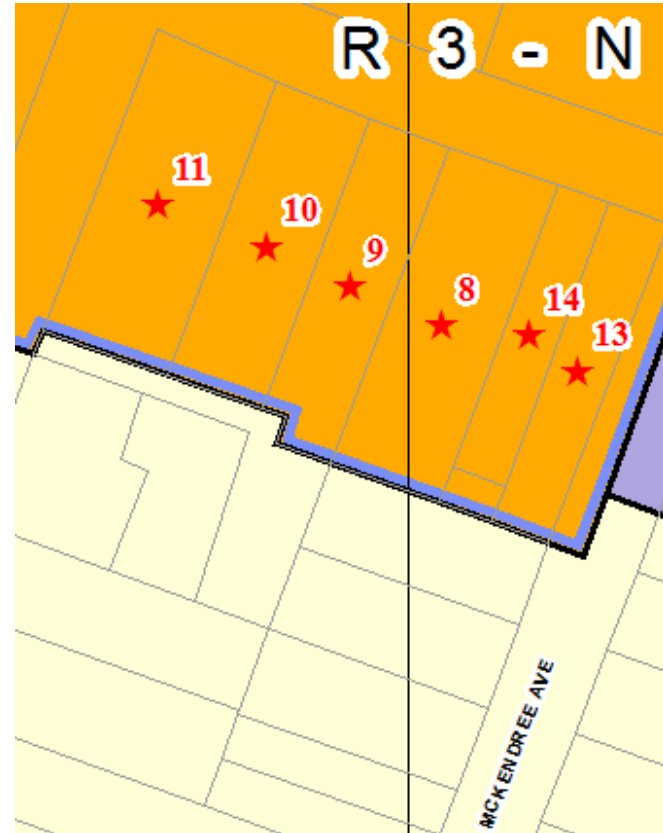

#	Map #	Area Title	Ordinance/ Reference	
	Parcel ID	Change	Old	New
	Address			
	51B	Outer West St Area		
1	020600090059195	An error was made while digitizing documents for the 2005 Zoning Maps –	0-43-88A	
	8 S. Cherry Grove Ave	This parcel is now correctly zoned as all R3-NC.	Split w/ R2	All R3-NC
2	020600090059194	An error was made while digitizing documents for the 2005 Zoning Maps –	0-43-88A	
	10 S. Cherry Grove Ave	This parcel is now correctly zoned as all R3-NC.	R2	R3-NC
3	020600090059193	An error was made while digitizing documents for the 2005 Zoning Maps –	0-43-88A	
	12 S. Cherry Grove Ave	This parcel is now correctly zoned as all R3-NC.	R2	R3-NC
4	020600090059192	An error was made while digitizing documents for the 2005 Zoning Maps –	0-43-88A	
	14 S. Cherry Grove Ave	This parcel is now correctly zoned as all R3-NC.	R2	R3-NC
5	020667590012349	An error was made while digitizing documents for the 2005 Zoning Maps –	O-43-88A	
	3 N. Homeland Ave.	The parcel is now correctly zoned as all R2.	10% split w/ R3	All R2
6	020667500835800	An error was made while digitizing documents for the 2005 Zoning Maps –	0-43-88A	
	8 N. Homeland Ave.	This parcel is now correctly zoned as all R2.	20% split w/ R3-NC	All R2
7	020667501111600	An error was made while digitizing documents for the 2005 Zoning Maps –	0-43-88A	
	3 N. Southwood Ave.	This parcel is now correctly zoned as all R2 and now has the correct address (#3 and #5 were reversed).	20% split w/ R3-NC	All R2
8	020600008035800	An error was made while digitizing documents for the 2005 Zoning Maps –	0-43-88A	
	1305 West St.	This parcel is now correctly zoned as ALL R3-NC.	25% split w/ R2	All R3-NC
9	020600001062012	An error was made while digitizing documents for the 2005 Zoning Maps –	0-43-88A	
	1309 West St.	This parcel is now correctly zoned as ALL R3-NC.	25% split w/ R2	All R3-NC
10	020600002802500	An error was made while digitizing documents for the 2005 Zoning Maps –	0-43-88A	
	1311 West St.	This parcel is now correctly zoned as ALL R3-NC.	40% split w/ R2	All R3-NC
11	020600002802105	An error was made while digitizing documents for the 2005 Zoning Maps –	O-43-88A	
	1313 West St	This parcel is now correctly zoned as ALL R3-NC.	50% split w/ R2	All R3-NC
12	020600001889000	An error was made while digitizing documents for the 2005 Zoning Maps –	Correct parcel lines and O-43-88A	
	1407 West St.	The parcel line accuracy is now up to date.	50% split w/ R2	90% R3-NC

51C		Inner West St. and Taylor Ave. Areas	
13	020600090023839	An error was made while digitizing documents for the 2005 Zoning Maps –	O-43-88A
	1301 West St.	This parcel is now correctly zoned as ALL R3-NC.	20% split w/ R2 All R3-NC
14	020600008276800	An error was made while digitizing documents for the 2005 Zoning Maps –	O-43-88A
	1303 West St.	This parcel is now correctly zoned as ALL R3-NC.	20% split w/ R2 All R3-NC

2005

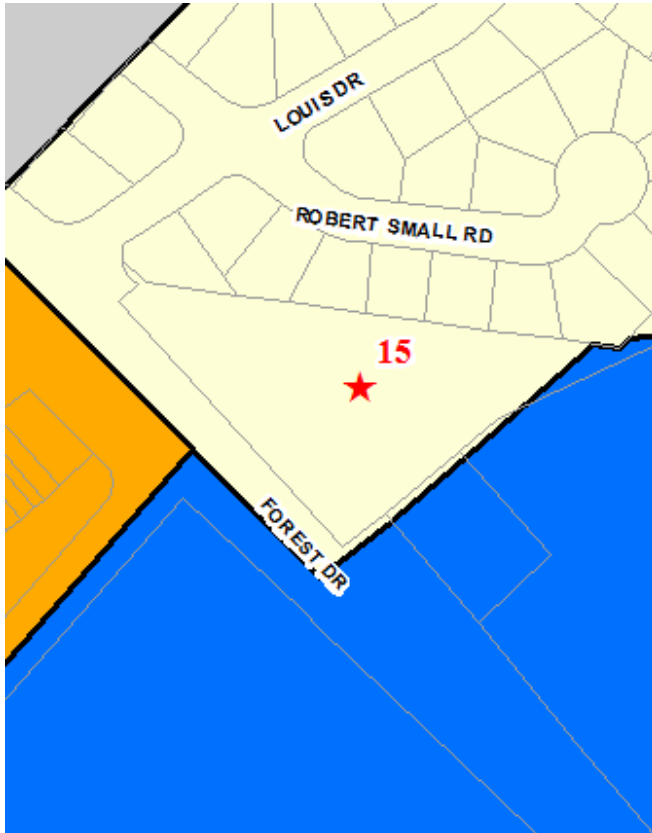

2015

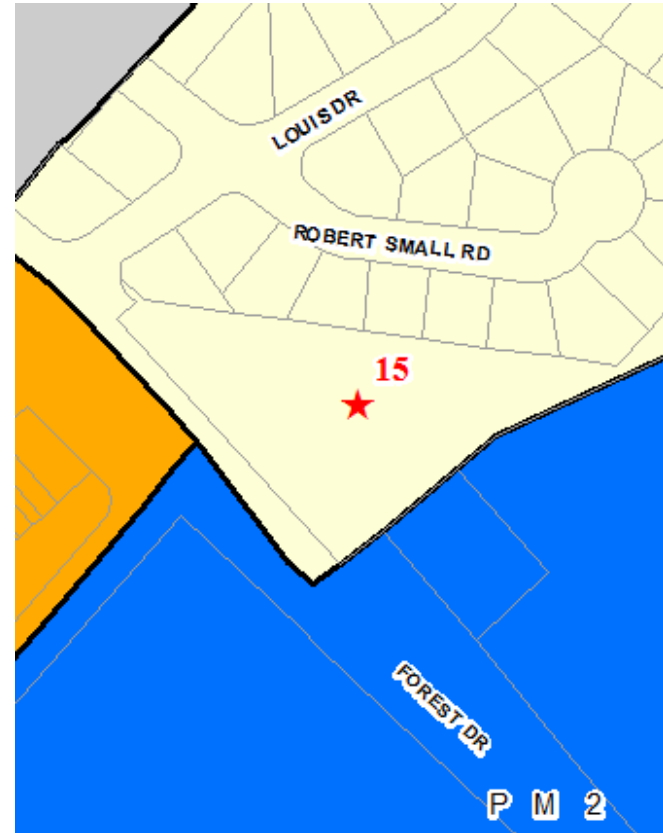

	51E	Aris T. Allen Blvd. and Forest Dr. Areas		
15	020600001406373	An error was made while digitizing documents for the 2005 Zoning Maps –	1993 Zoning Maps	
	1790 Forest Dr. p.0161	This parcel is now correctly zoned as ALL R2.	Split w/ PM2 on rear	All R2
16	020633001733000	An error was made while digitizing documents for the 2005 Zoning Maps –	1993 Zoning Maps	
	403 S Cherry Grove Ave	This parcel is now correctly zoned as ALL R1.	25% split w/ R3	All R1
17	020633003473215	An error was made while digitizing documents for the 2005 Zoning Maps –	1993 Zoning Maps	
	405 S Cherry Grove Ave	This parcel is now correctly zoned as ALL R1.	R3	R1
18	020633008691600	An error was made while digitizing documents for the 2005 Zoning Maps –	1993 Zoning Maps	
	402 Merryman Rd	This parcel is now correctly zoned as ALL R1.	10% split w/ R3	All R1
19	020633008685000	An error was made while digitizing documents for the 2005 Zoning Maps –	1993 Zoning Maps	
	404 Merryman Rd	This parcel is now correctly zoned as ALL R1.	75% split w/ R3	All R1
20	020633001980130	An error was made while digitizing documents for the 2005 Zoning Maps –	1993 Zoning Maps	
	406 Merryman Rd	This parcel is now correctly zoned as ALL R1.	75% split w/ R3	All R1
21	020633006725500	An error was made while digitizing documents for the 2005 Zoning Maps –	1993 Zoning Maps	
	408 Merryman Rd	This parcel is now correctly zoned as ALL R1.	Split w/ R3	All R1
22	020633003742205	An error was made while digitizing documents for the 2005 Zoning Maps –	1993 Zoning Maps	
	410 Merryman Rd	This parcel is now correctly zoned as ALL R1.	25% split w/ R3	All R1
23	Condominiums	An error was made while digitizing documents for the 2005 Zoning Maps –	1993 Zoning Maps	
	Heritage Ct p.1874	This parcel is now correctly zoned as ALL R3.	10% split w/ R1	All R3

2005

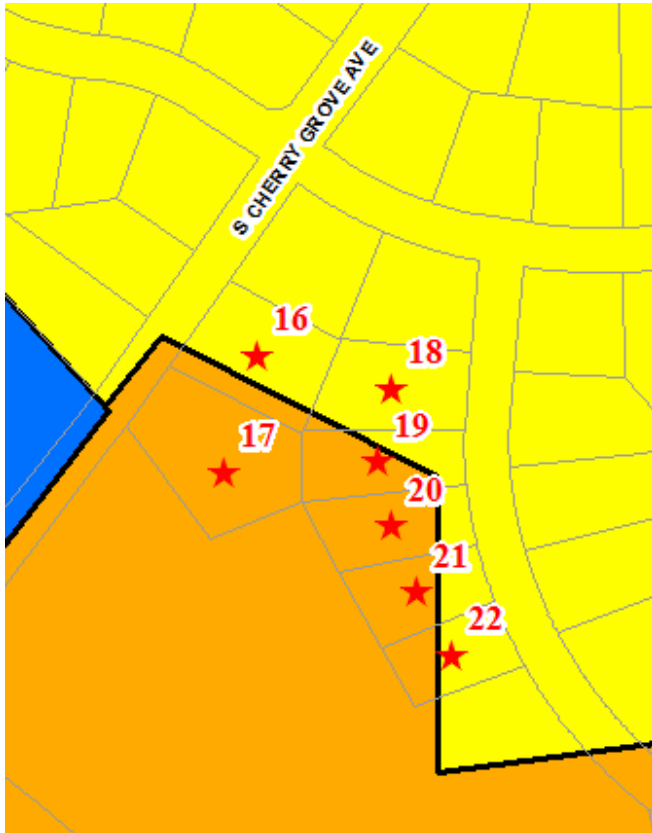

2015

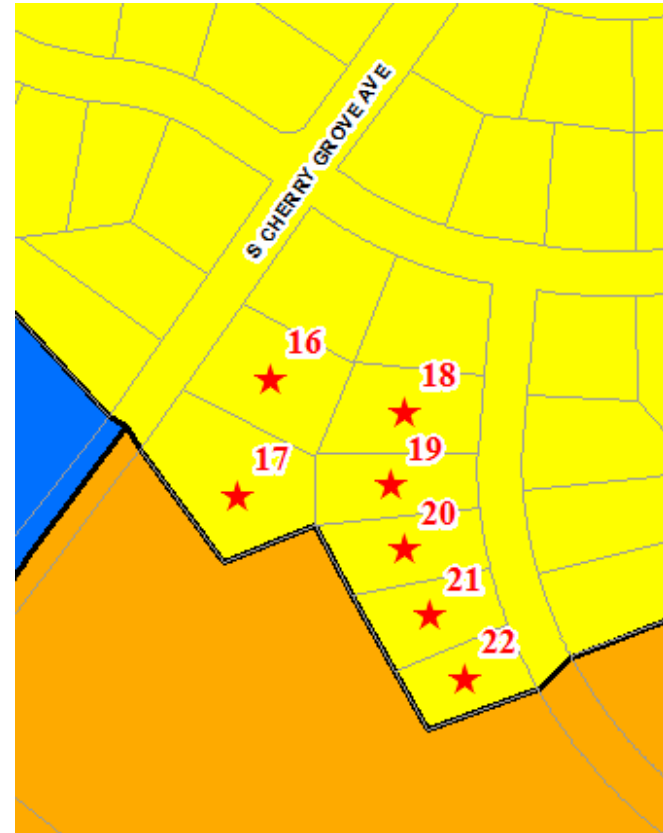

51E		Aris T. Allen Blvd. and Forest Dr. Areas	
15	020600001406373 1790 Forest Dr. p.0161	An error was made while digitizing documents for the 2005 Zoning Maps – This parcel is now correctly zoned as ALL R2.	1993 Zoning Maps Split w/ PM2 on rear All R2
16	020633001733000 403 S Cherry Grove Ave	An error was made while digitizing documents for the 2005 Zoning Maps – This parcel is now correctly zoned as ALL R1.	1993 Zoning Maps 25% split w/ R3 All R1
17	020633003473215 405 S Cherry Grove Ave	An error was made while digitizing documents for the 2005 Zoning Maps – This parcel is now correctly zoned as ALL R1.	1993 Zoning Maps R3 R1
18	020633008691600 402 Merryman Rd	An error was made while digitizing documents for the 2005 Zoning Maps – This parcel is now correctly zoned as ALL R1.	1993 Zoning Maps 10% split w/ R3 All R1
19	020633008685000 404 Merryman Rd	An error was made while digitizing documents for the 2005 Zoning Maps – This parcel is now correctly zoned as ALL R1.	1993 Zoning Maps 75% split w/ R3 All R1
20	020633001980130 406 Merryman Rd	An error was made while digitizing documents for the 2005 Zoning Maps – This parcel is now correctly zoned as ALL R1.	1993 Zoning Maps 75% split w/ R3 All R1
21	020633006725500 408 Merryman Rd	An error was made while digitizing documents for the 2005 Zoning Maps – This parcel is now correctly zoned as ALL R1.	1993 Zoning Maps Split w/ R3 All R1
22	020633003742205 410 Merryman Rd	An error was made while digitizing documents for the 2005 Zoning Maps – This parcel is now correctly zoned as ALL R1.	1993 Zoning Maps 25% split w/ R3 All R1
23	Condominiums Heritage Ct p.1874	An error was made while digitizing documents for the 2005 Zoning Maps – This parcel is now correctly zoned as ALL R3.	1993 Zoning Maps 10% split w/ R1 All R3

2005

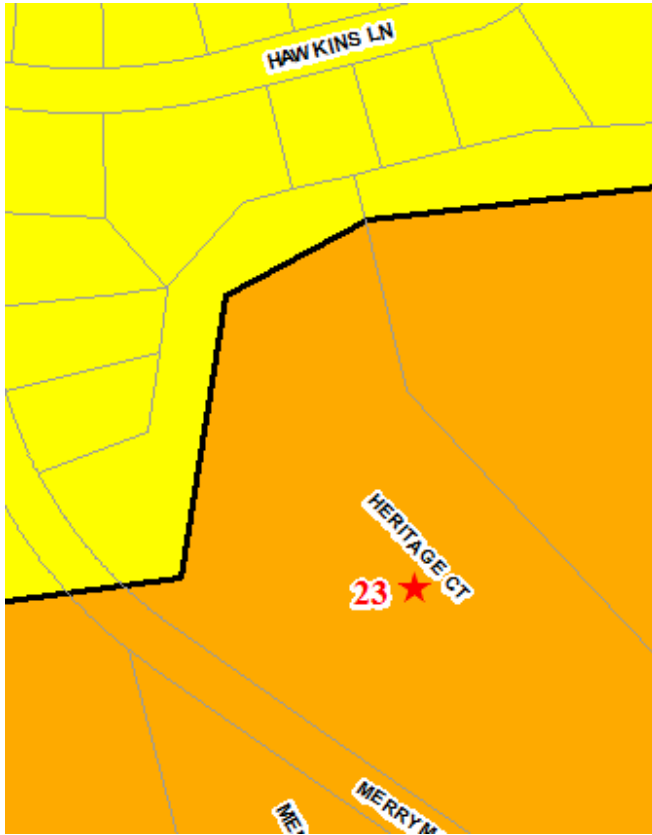

2015

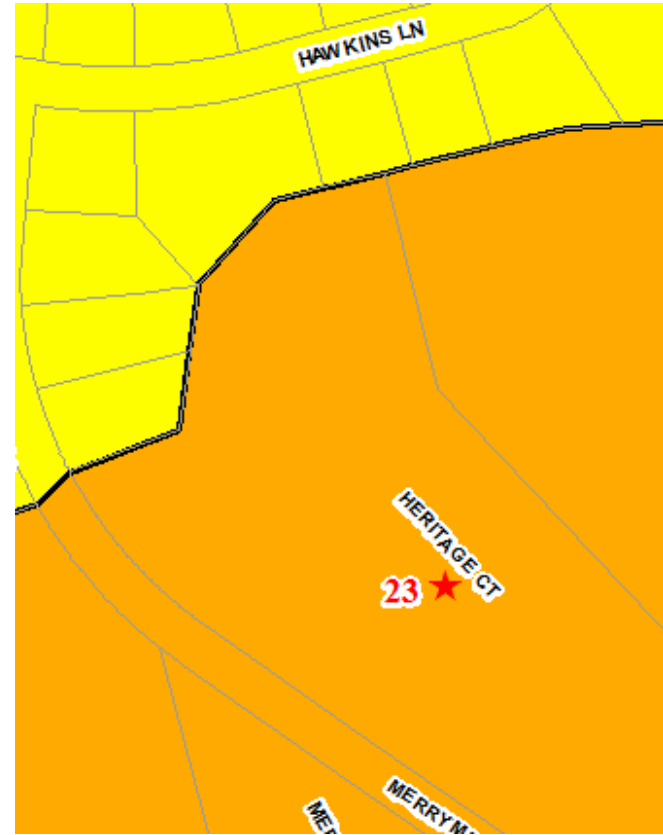

23	Condominiums	An error was made while digitizing documents for the 2005 Zoning Maps –	1993 Zoning Maps
	Heritage Ct p.1874	This parcel is now correctly zoned as ALL R3.	10% split w/ R1 All R3

2005

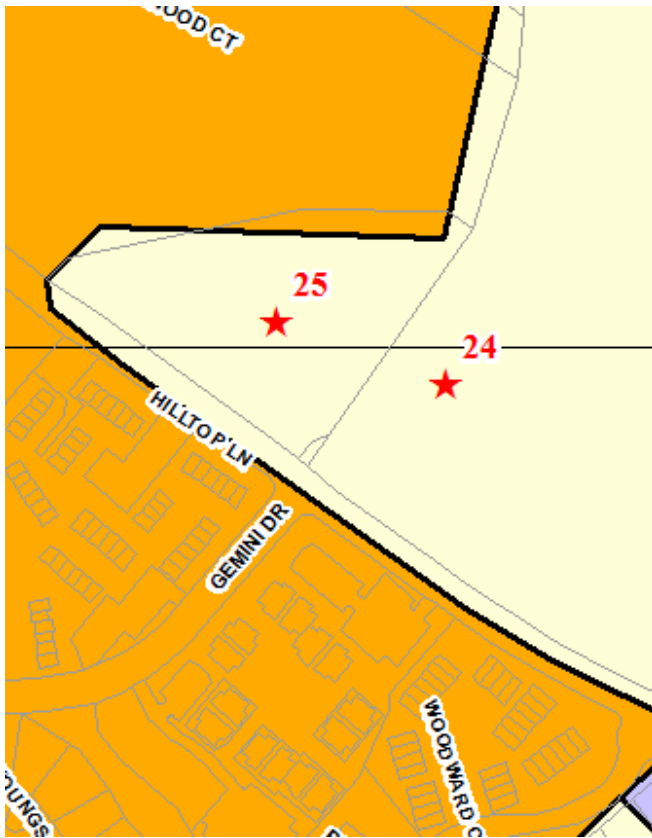

2015

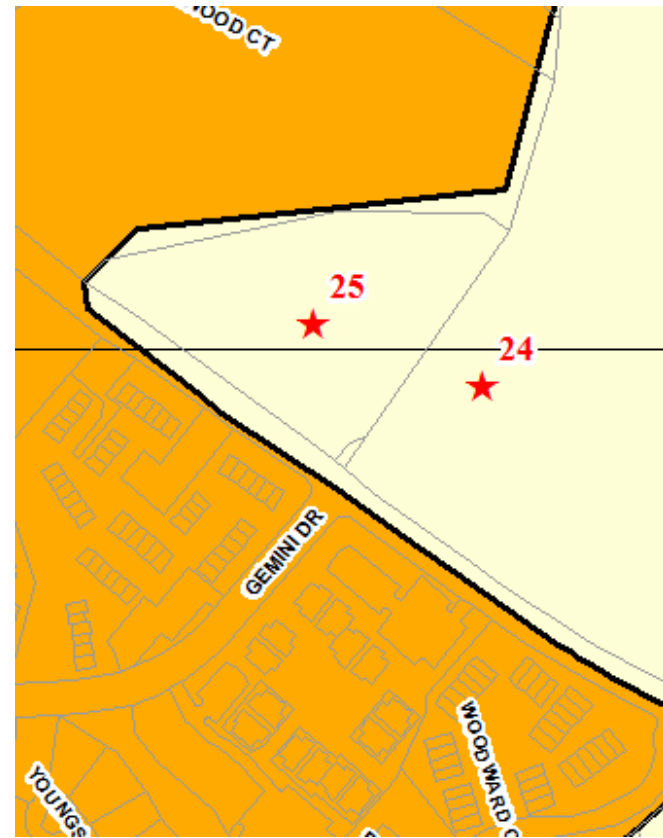

51F		Hilltop Ln. and Spa Rd. Areas	
24	020600001407402	An error was made while digitizing documents for the 2005 Zoning Maps.–	1993 Zoning Maps
	Hilltop Ln. p.0015	The R2 and R3 lines are now correct.	R3/R2 lines shifted
25	020600009176520	An error was made while digitizing documents for the 2005 Zoning Maps.–	1993 Zoning Maps
	351 Hilltop Ln. p.2112	The R2 and R3 lines are now correct.	R3/R2 lines shifted

2005

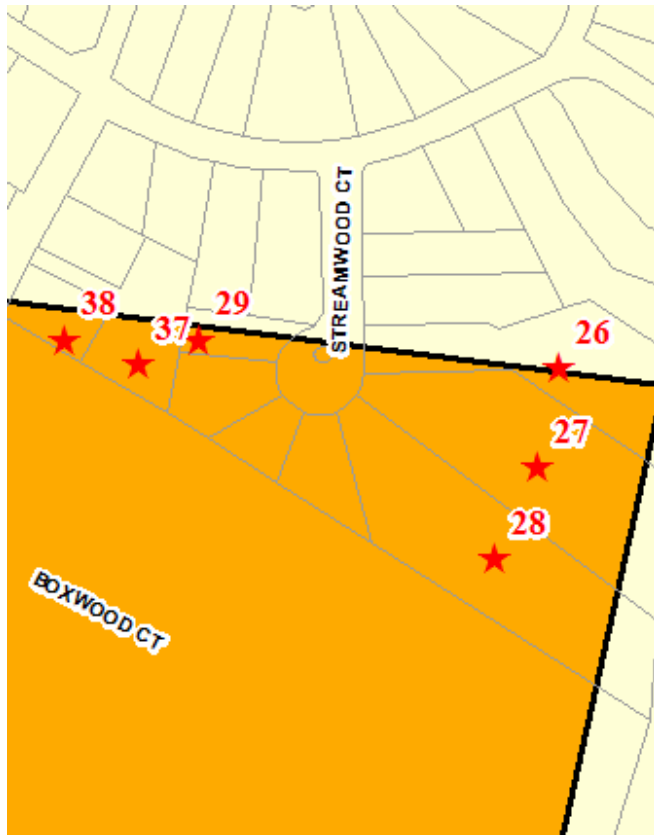

2015

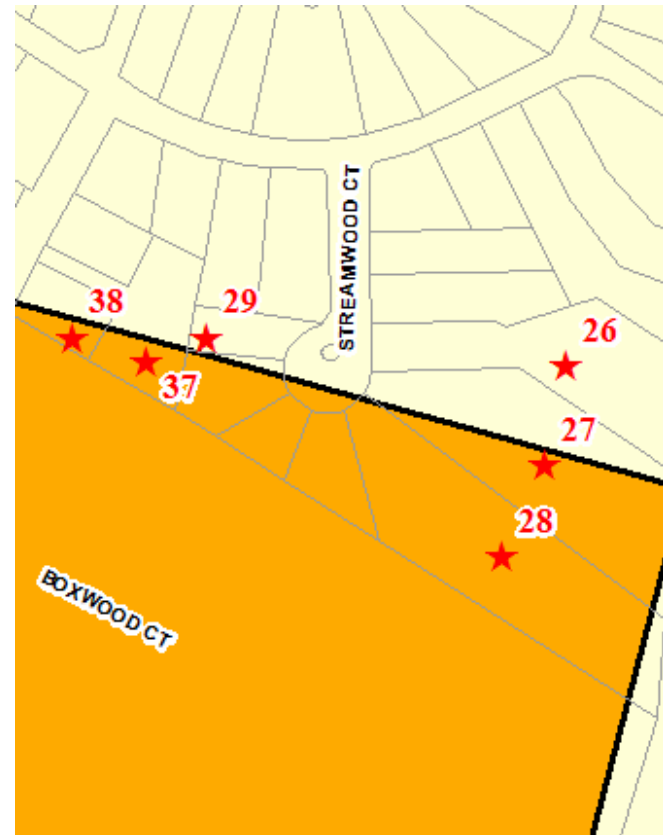

51F		Hilltop Ln. and Spa Rd. Areas	
24	020600001407402	An error was made while digitizing documents for the 2005 Zoning Maps.–	1993 Zoning Maps
	Hilltop Ln. p.0015	The R2 and R3 lines are now correct.	R3/R2 lines shifted
25	020600009176520	An error was made while digitizing documents for the 2005 Zoning Maps.–	1993 Zoning Maps
	351 Hilltop Ln. p.2112	The R2 and R3 lines are now correct.	R3/R2 lines shifted
26	020682890035114	An error was made while digitizing documents for the 2005 Zoning Maps.–	1993 Zoning Maps
	4 Streamwood Ct.	The parcel is now all R2.	50% split w/ R3 All R2
27	020682890035112	An error was made while digitizing documents for the 2005 Zoning Maps.–	1993 Zoning Maps
	5 Streamwood Ct.	The parcel is now split R2 and R3.	All R3 Split R2 and R3
28	020682890035111	An error was made while digitizing documents for the 2005 Zoning Maps.–	1993 Zoning Maps
	6 Streamwood Ct.	The parcel is now split R2 and R3.	All R3 Split R2 and R3
29	020682890045865	An error was made while digitizing documents for the 2005 Zoning Maps.–	1993 Zoning Maps
	10 Streamwood Ct.	The parcel is now zoned as ALL R2.	Split All R2
30	020682990084117	An error was made while digitizing documents for the 2005 Zoning Maps.–	1993 Zoning Maps
	4 Silopanna Ct.	The R2 and R3 lines are now correct.	R3 and R2 lines shifted
31	020600090086067	There was an error in original drafting of ordinance O-27-76.	O-27-76
	020600002725207	The parcel is now correctly shown as ALL P.	Shown w/ R3 All P
	1606 Forest Dr.	See Map 51I for overflow	
32	020600005293409	There was an error in original drafting of ordinance O-27-76.	O-27-76
	1614 Forest Dr.	The parcel is now correctly shown as ALL P.	Shown w/ R3 All P
33	020600005293408	There was an error in original drafting of ordinance O-27-76.	O-27-76
	1616 Forest Dr.	The parcel is now correctly shown as ALL P.	Shown w/ R3 All P
34	020652590019842	There was an error in original drafting of ordinance O-27-76.	O-27-76
	1405 Jousting Ct.	The parcel is now correctly shown as ALL R3.	Shown w/ P All R3
35	020652590019845	There was an error in original drafting of ordinance O-27-76.	O-27-76
	1406 Jousting Ct.	The parcel is now correctly shown as ALL R3.	Shown w/ P All R3
36	020652590019843	There was an error in original drafting of ordinance O-27-76.	O-27-76
	1407 Jousting Ct.	The parcel is now correctly shown as ALL R3.	Shown w/ P All R3
37	020682990004155	An error was made while digitizing documents for the 2005 Zoning Maps.	1993 Zoning Maps
	105 Boxwood Rd		70% R2 and 30%R3 75% R2 25% R3
38	020682990004156	An error was made while digitizing documents for the 2005 Zoning Maps	1993 Zoning Maps
	107 Boxwood Rd		45% R2 and 65%R3 50% split R2/R3

2005

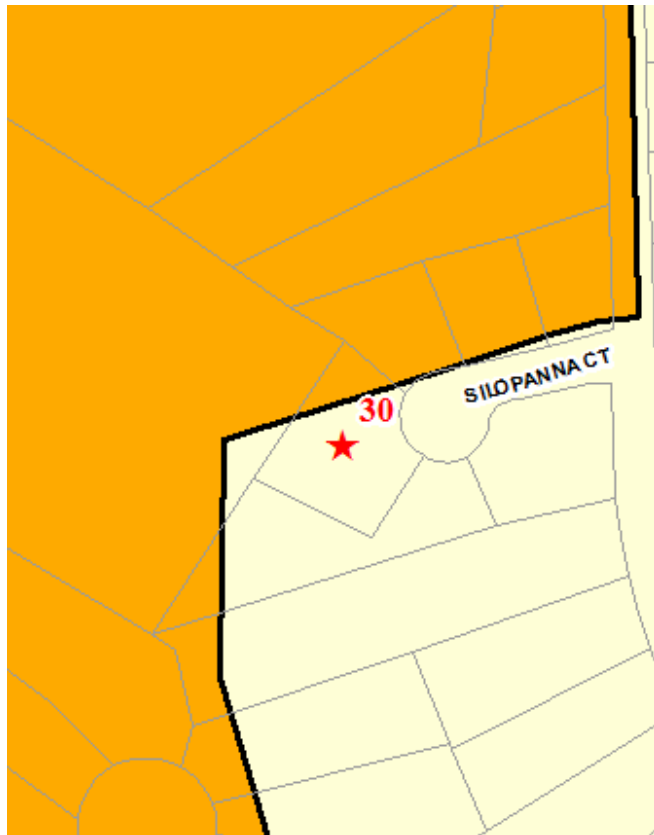

2015

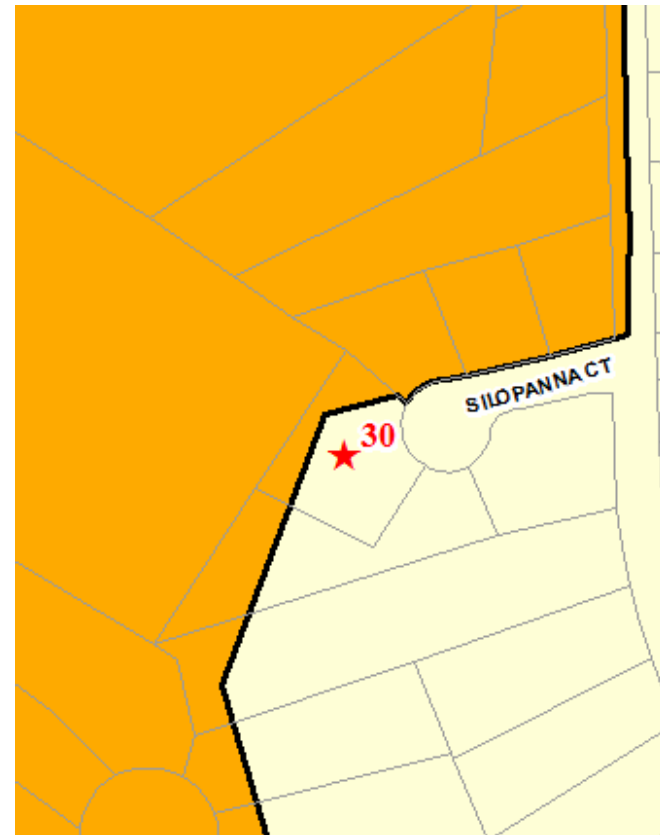

30	020682990084117	An error was made while digitizing documents for the 2005 Zoning Maps. –	1993 Zoning Maps
	4 Silopanna Ct.	The R2 and R3 lines are now correct.	R3 and R2 lines shifted

2005

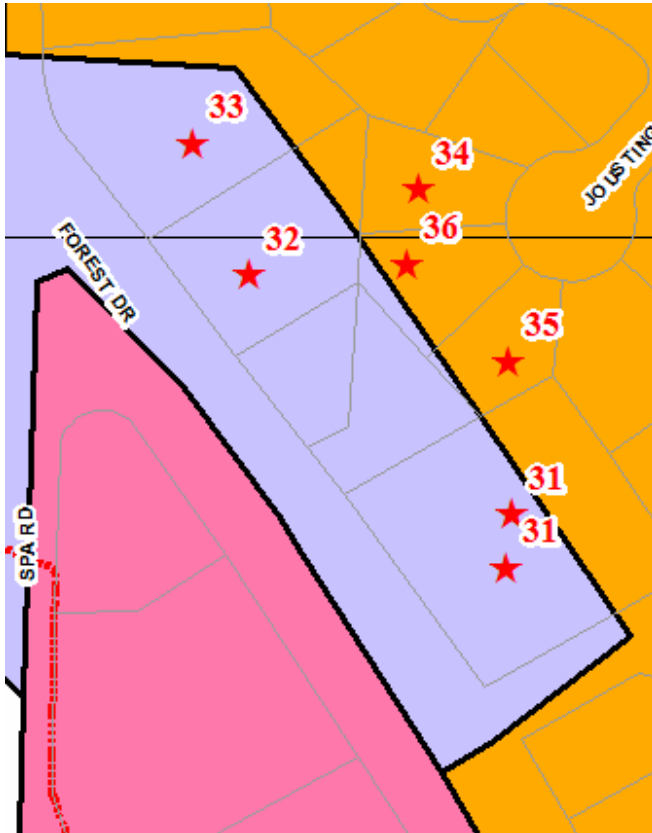

2015

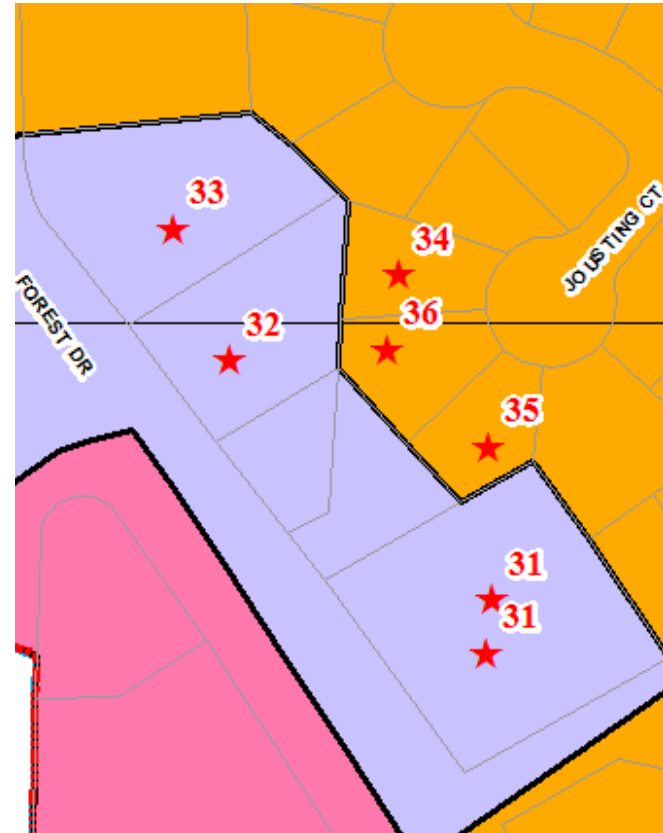

51F		Hilltop Ln. and Spa Rd. Areas	
24	020600001407402	An error was made while digitizing documents for the 2005 Zoning Maps.–	1993 Zoning Maps
	Hilltop Ln. p.0015	The R2 and R3 lines are now correct.	R3/R2 lines shifted
25	020600009176520	An error was made while digitizing documents for the 2005 Zoning Maps.–	1993 Zoning Maps
	351 Hilltop Ln. p.2112	The R2 and R3 lines are now correct.	R3/R2 lines shifted
26	020682890035114	An error was made while digitizing documents for the 2005 Zoning Maps.–	1993 Zoning Maps
	4 Streamwood Ct.	The parcel is now all R2.	50% split w/ R3 All R2
27	020682890035112	An error was made while digitizing documents for the 2005 Zoning Maps.–	1993 Zoning Maps
	5 Streamwood Ct.	The parcel is now split R2 and R3.	All R3 Split R2 and R3
28	020682890035111	An error was made while digitizing documents for the 2005 Zoning Maps.–	1993 Zoning Maps
	6 Streamwood Ct.	The parcel is now split R2 and R3.	All R3 Split R2 and R3
29	020682890045865	An error was made while digitizing documents for the 2005 Zoning Maps.–	1993 Zoning Maps
	10 Streamwood Ct.	The parcel is now zoned as ALL R2.	Split All R2
30	020682990084117	An error was made while digitizing documents for the 2005 Zoning Maps.–	1993 Zoning Maps
	4 Silopanna Ct.	The R2 and R3 lines are now correct.	R3 and R2 lines shifted
31	020600090086067	There was an error in original drafting of ordinance O-27-76.	O-27-76
	020600002725207	The parcel is now correctly shown as ALL P.	Shown w/ R3 All P
	1606 Forest Dr.	See Map 51I for overflow	
32	020600005293409	There was an error in original drafting of ordinance O-27-76.	O-27-76
	1614 Forest Dr.	The parcel is now correctly shown as ALL P.	Shown w/ R3 All P
33	020600005293408	There was an error in original drafting of ordinance O-27-76.	O-27-76
	1616 Forest Dr.	The parcel is now correctly shown as ALL P.	Shown w/ R3 All P
34	020652590019842	There was an error in original drafting of ordinance O-27-76.	O-27-76
	1405 Jousting Ct.	The parcel is now correctly shown as ALL R3.	Shown w/ P All R3
35	020652590019845	There was an error in original drafting of ordinance O-27-76.	O-27-76
	1406 Jousting Ct.	The parcel is now correctly shown as ALL R3.	Shown w/ P All R3
36	020652590019843	There was an error in original drafting of ordinance O-27-76.	O-27-76
	1407 Jousting Ct.	The parcel is now correctly shown as ALL R3.	Shown w/ P All R3
37	020682990004155	An error was made while digitizing documents for the 2005 Zoning Maps.	1993 Zoning Maps
	105 Boxwood Rd		70% R2 and 30%R3 75% R2 25% R3
38	020682990004156	An error was made while digitizing documents for the 2005 Zoning Maps	1993 Zoning Maps
	107 Boxwood Rd		45% R2 and 65%R3 50% split R2/R3

2005

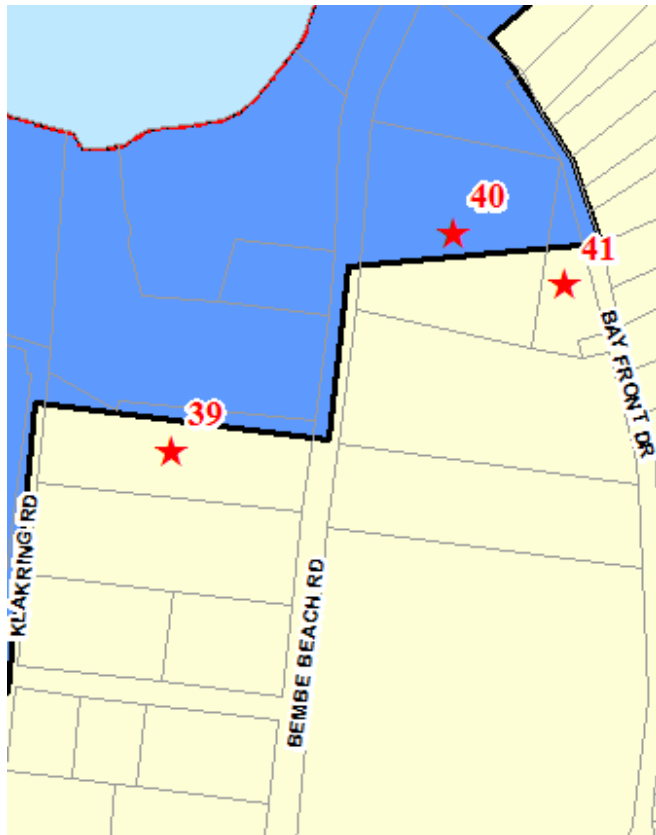

2015

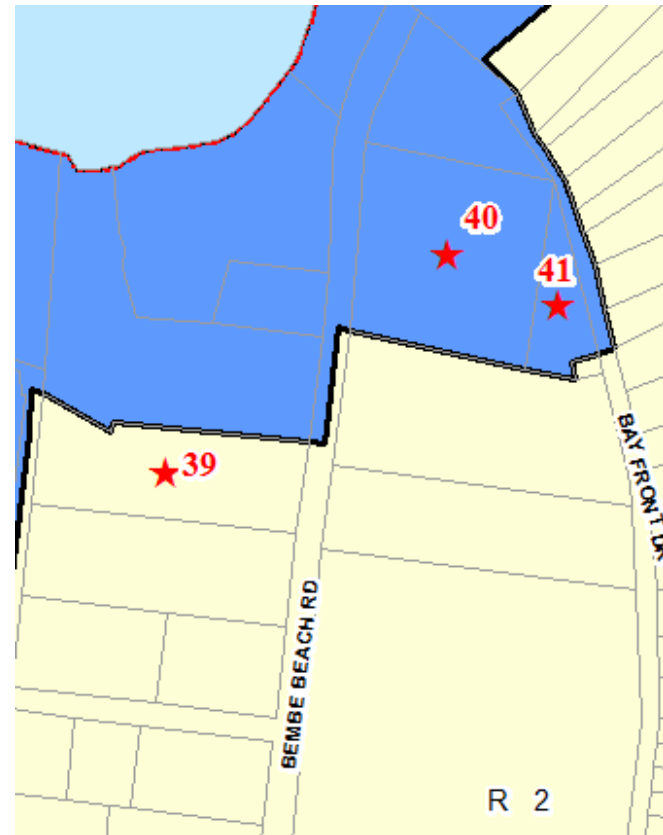

	52D	Eastport and Bembe Beach Peninsula Areas		
39	020600090026340	An error was made while digitizing documents for the 2005 Zoning Maps. – The parcel is now zoned as ALL R2.	0-49-87A and 0-49-87	
	7038 Bembe Beach Rd.		Split w/ WMI	All R2
40	020600090013685	An error was made while digitizing documents for the 2005 Zoning Maps – The parcel is now zoned as ALL WMI.	0-49-87A and 0-49-87	
	Bembe Beach Rd. p.2469		Split w/ R2	All WMI
41	020600090215947	An error was made while digitizing documents for the 2005 Zoning Maps – The parcel is now zoned as ALL WMI.	0-49-87A and 0-49-87	
	Bay Front Dr. p.2455		Split w/ R2	All WMI
42	020600007040600	An error was made while digitizing documents for the 2005 Zoning Maps. – The parcel is now zoned as ALL WME.	0-49-87A and 0-49-87	
	808 Boucher Ave.		Split w/ R2	All WME
43	020600007682000	An error was made while digitizing documents for the 2005 Zoning Maps. – The parcel is now zoned as ALL WME.	0-49-87A and 0-49-87	
	814 Boucher Ave.		Split w/ R2	All WME
44	020600005962100	An error was made while digitizing documents for the 2005 Zoning Maps. – The parcel is now zoned as ALL WME.	0-49-87A and 0-49-87	
	309 Burnside Ave.		Split w/ R2-NC	All WME

2005

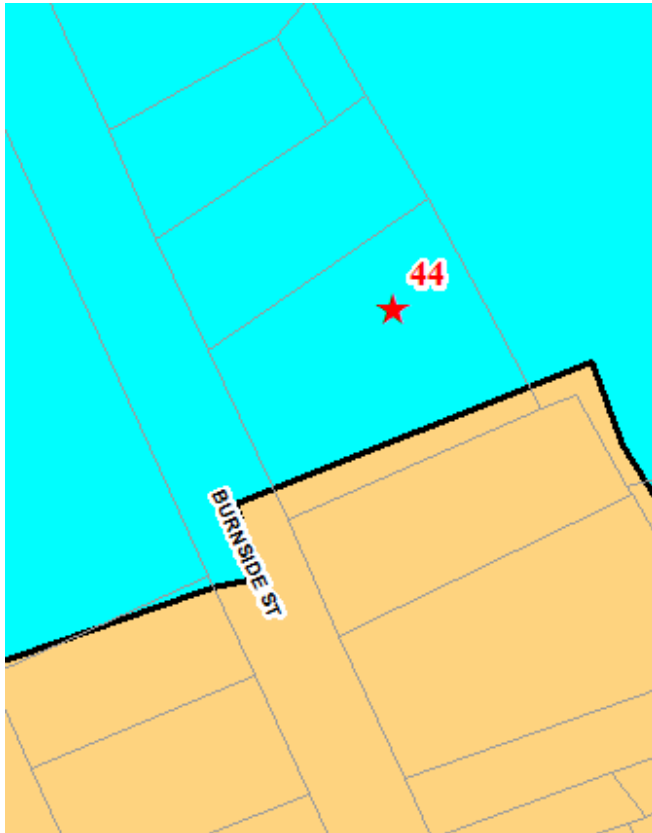

2015

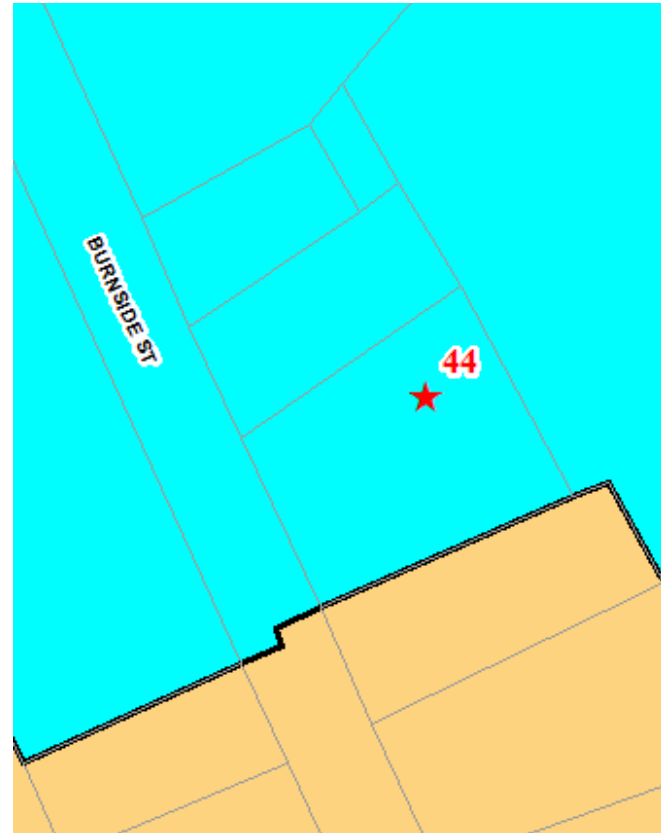

	52D	Eastport and Bembe Beach Peninsula Areas		
39	020600090026340	An error was made while digitizing documents for the 2005 Zoning Maps. – The parcel is now zoned as ALL R2.	0-49-87A and 0-49-87	
	7038 Bembe Beach Rd.		Split w/ WMI	All R2
40	020600090013685	An error was made while digitizing documents for the 2005 Zoning Maps – The parcel is now zoned as ALL WMI.	0-49-87A and 0-49-87	
	Bembe Beach Rd. p.2469		Split w/ R2	All WMI
41	020600090215947	An error was made while digitizing documents for the 2005 Zoning Maps – The parcel is now zoned as ALL WMI.	0-49-87A and 0-49-87	
	Bay Front Dr. p.2455		Split w/ R2	All WMI
42	020600007040600	An error was made while digitizing documents for the 2005 Zoning Maps. – The parcel is now zoned as ALL WME.	0-49-87A and 0-49-87	
	808 Boucher Ave.		Split w/ R2	All WME
43	020600007682000	An error was made while digitizing documents for the 2005 Zoning Maps. – The parcel is now zoned as ALL WME.	0-49-87A and 0-49-87	
	814 Boucher Ave.		Split w/ R2	All WME
44	020600005962100	An error was made while digitizing documents for the 2005 Zoning Maps. – The parcel is now zoned as ALL WME.	0-49-87A and 0-49-87	
	309 Burnside Ave.		Split w/ R2-NC	All WME

2005

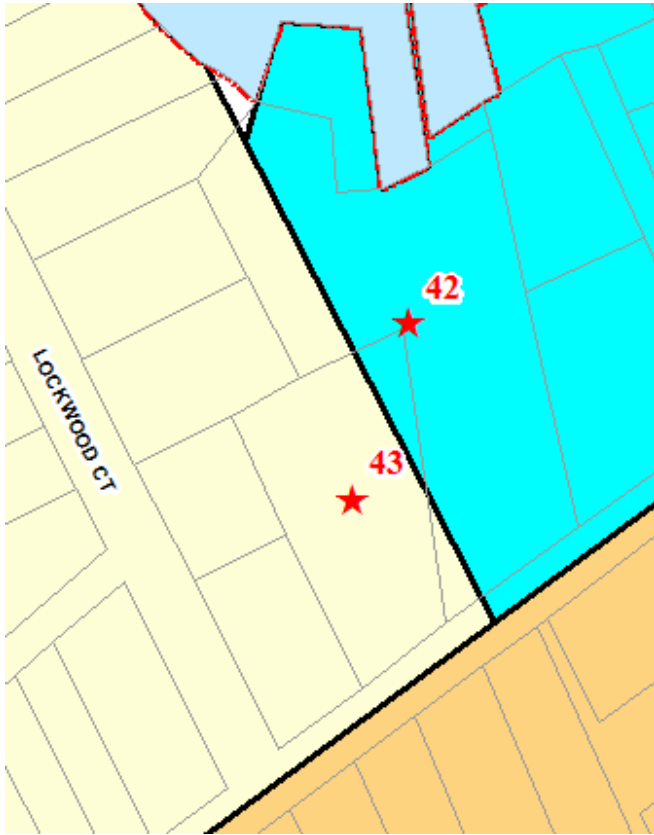

2015

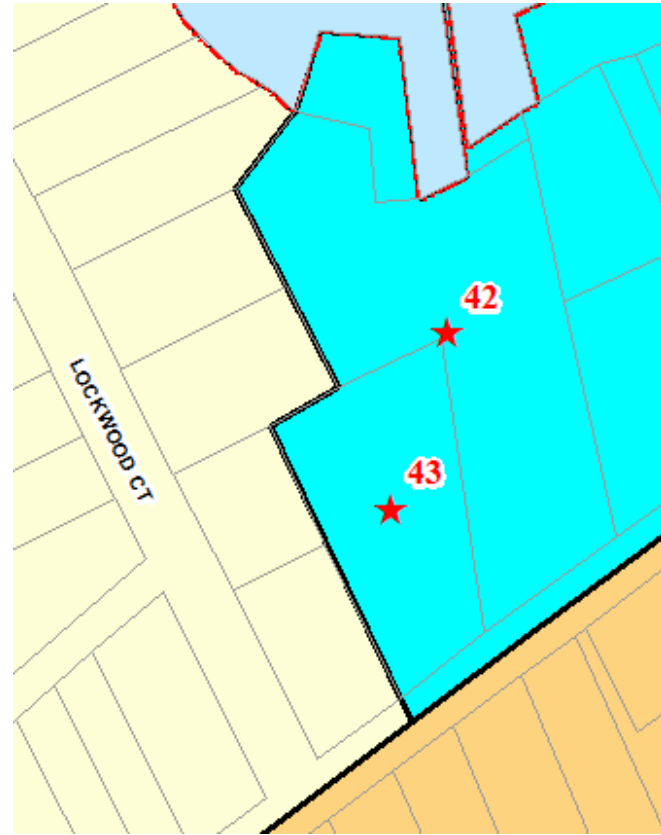

52D		Eastport and Bembe Beach Peninsula Areas	
39	020600090026340	An error was made while digitizing documents for the 2005 Zoning Maps. – The parcel is now zoned as ALL R2.	0-49-87A and 0-49-87
	7038 Bembe Beach Rd.		Split w/ WMI All R2
40	020600090013685	An error was made while digitizing documents for the 2005 Zoning Maps – The parcel is now zoned as ALL WMI.	0-49-87A and 0-49-87
	Bembe Beach Rd. p.2469		Split w/ R2 All WMI
41	020600090215947	An error was made while digitizing documents for the 2005 Zoning Maps – The parcel is now zoned as ALL WMI.	0-49-87A and 0-49-87
	Bay Front Dr. p.2455		Split w/ R2 All WMI
42	020600007040600	An error was made while digitizing documents for the 2005 Zoning Maps. – The parcel is now zoned as ALL WME.	0-49-87A and 0-49-87
	808 Boucher Ave.		Split w/ R2 All WME
43	020600007682000	An error was made while digitizing documents for the 2005 Zoning Maps. – The parcel is now zoned as ALL WME.	0-49-87A and 0-49-87
	814 Boucher Ave.		Split w/ R2 All WME
44	020600005962100	An error was made while digitizing documents for the 2005 Zoning Maps. – The parcel is now zoned as ALL WME.	0-49-87A and 0-49-87
	309 Burnside Ave.		Split w/ R2-NC All WME

2005

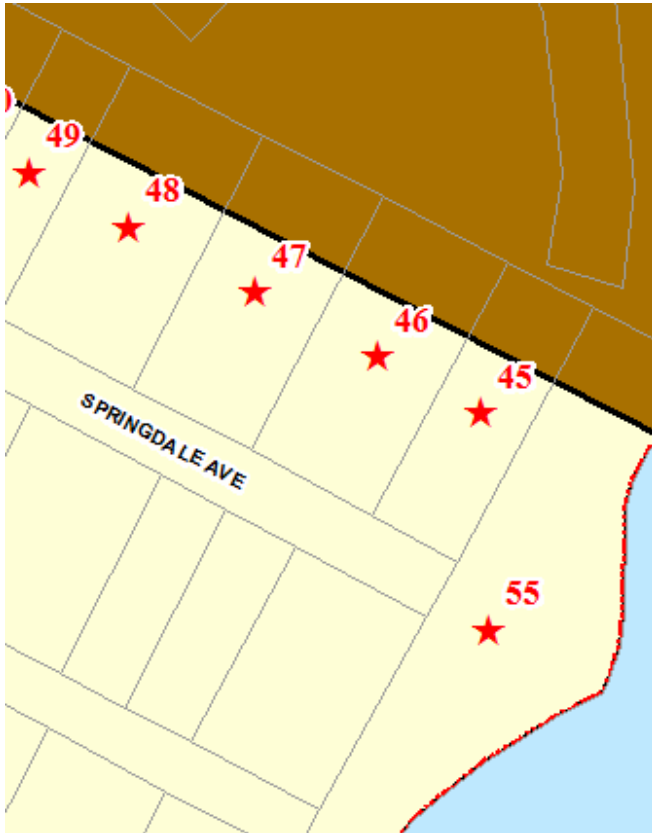

2015

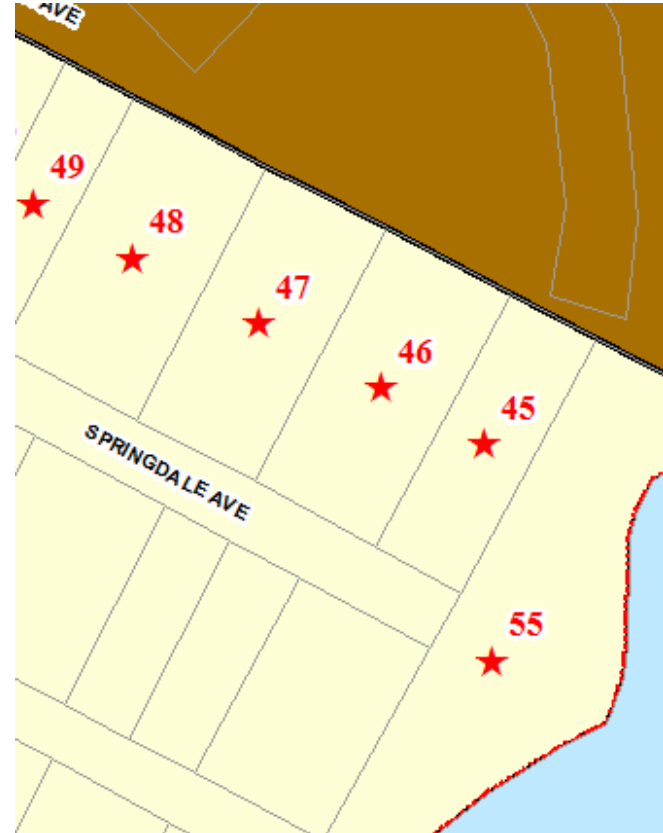

52G		Bay Ridge Ave. and Edgewood Rd. Areas		
45	020600003047800	An error was made while digitizing documents for the 2005 Zoning Maps – The parcel is now correctly zoned as ALL R2.	1993 Zoning Maps	
	700 Springdale Ave.		20% split w/ R4	All R2
46	020600009006200	An error was made while digitizing documents for the 2005 Zoning Maps – The parcel is now correctly zoned as ALL R2.	1993 Zoning Maps	
	706 Springdale Ave.		20% split w/ R4	All R2
47	020600003200160	An error was made while digitizing documents for the 2005 Zoning Maps – The parcel is now correctly zoned as ALL R2.	1993 Zoning Maps	
	708 Springdale Ave.		20% split w/ R4	All R2
48	020600005398400	An error was made while digitizing documents for the 2005 Zoning Maps – The parcel is now correctly zoned as ALL R2.	1993 Zoning Maps	
	710 Springdale Ave.		20% split w/ R4	All R2
49	020600090230641	An error was made while digitizing documents for the 2005 Zoning Maps – The parcel is now correctly zoned as ALL R2.	1993 Zoning Maps	
	714 Springdale Ave.		20% split w/ R4	All R2
50	020600002402400	An error was made while digitizing documents for the 2005 Zoning Maps – The parcel is now correctly zoned as ALL R2.	1993 Zoning Maps	
	716 Springdale Ave.		20% split w/ R4	All R2
51	020600090221056	An error was made while digitizing documents for the 2005 Zoning Maps – The parcel is now correctly zoned as ALL R2.	1993 Zoning Maps	
	718 Springdale Ave.		20% split w/ R4	All R2
52	020600007120400	An error was made while digitizing documents for the 2005 Zoning Maps – The parcel is now correctly zoned as ALL R2.	1993 Zoning Maps	
	720 Springdale Ave.		20% split w/ R4	All R2
53	020600090221055	An error was made while digitizing documents for the 2005 Zoning Maps – The parcel is now correctly zoned as ALL R2.	1993 Zoning Maps	
	722 Springdale Ave.		20% split w/ R4	All R2
54	020600004939200	An error was made while digitizing documents for the 2005 Zoning Maps – The parcel is now correctly zoned as ALL R2.	1993 Zoning Maps	
	728 Springdale Ave.		20% split w/ R4	All R2
55	020600006094900	An error was made while digitizing documents for the 2005 Zoning Maps – The parcel is now correctly zoned as ALL R2.	1993 Zoning Maps	
	Springdale Ave. p.0206		20% split w/ R4	All R2
56	020600090007688	An error was made while digitizing documents for the 2005 Zoning Maps – The parcel is now correctly zoned as ALL R2.	1993 Zoning Maps	
	790 Parkwood Ave.		20% split w/ R4	All R2

2005

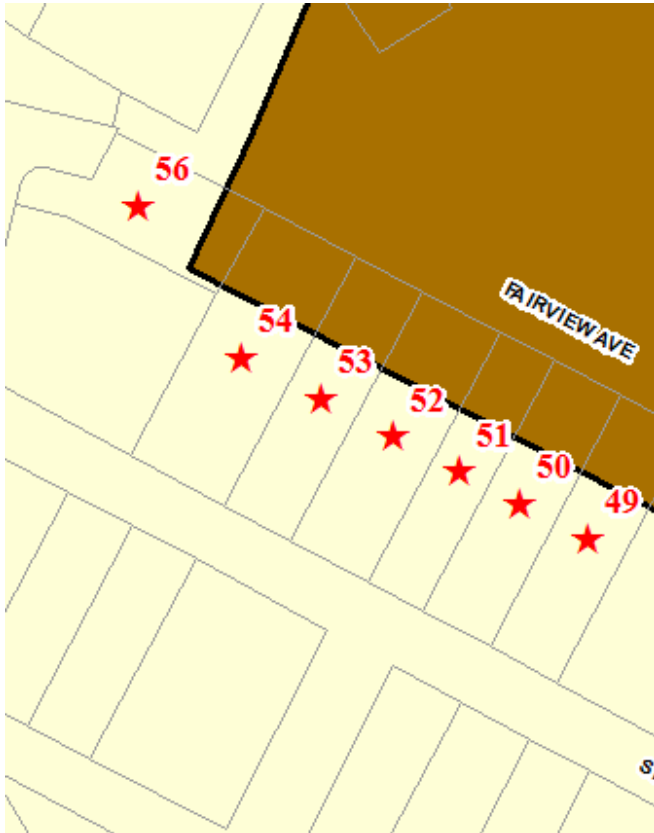

2015

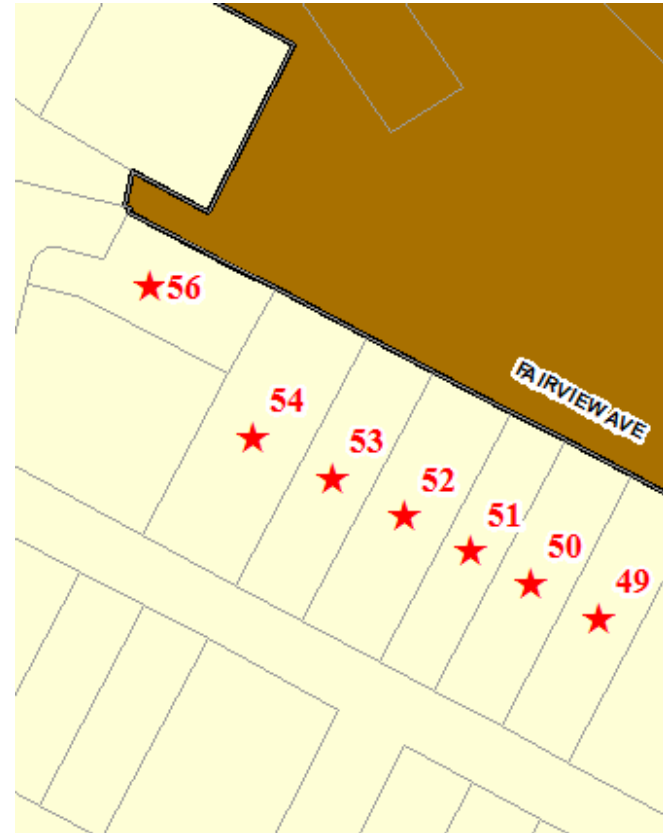

	52G	Bay Ridge Ave. and Edgewood Rd. Areas		
45	020600003047800	An error was made while digitizing documents for the 2005 Zoning Maps – The parcel is now correctly zoned as ALL R2.	1993 Zoning Maps	
	700 Springdale Ave.		20% split w/ R4	All R2
46	020600009006200	An error was made while digitizing documents for the 2005 Zoning Maps – The parcel is now correctly zoned as ALL R2.	1993 Zoning Maps	
	706 Springdale Ave.		20% split w/ R4	All R2
47	020600003200160	An error was made while digitizing documents for the 2005 Zoning Maps – The parcel is now correctly zoned as ALL R2.	1993 Zoning Maps	
	708 Springdale Ave.		20% split w/ R4	All R2
48	020600005398400	An error was made while digitizing documents for the 2005 Zoning Maps – The parcel is now correctly zoned as ALL R2.	1993 Zoning Maps	
	710 Springdale Ave.		20% split w/ R4	All R2
49	020600090230641	An error was made while digitizing documents for the 2005 Zoning Maps – The parcel is now correctly zoned as ALL R2.	1993 Zoning Maps	
	714 Springdale Ave.		20% split w/ R4	All R2
50	020600002402400	An error was made while digitizing documents for the 2005 Zoning Maps – The parcel is now correctly zoned as ALL R2.	1993 Zoning Maps	
	716 Springdale Ave.		20% split w/ R4	All R2
51	020600090221056	An error was made while digitizing documents for the 2005 Zoning Maps – The parcel is now correctly zoned as ALL R2.	1993 Zoning Maps	
	718 Springdale Ave.		20% split w/ R4	All R2
52	020600007120400	An error was made while digitizing documents for the 2005 Zoning Maps – The parcel is now correctly zoned as ALL R2.	1993 Zoning Maps	
	720 Springdale Ave.		20% split w/ R4	All R2
53	020600090221055	An error was made while digitizing documents for the 2005 Zoning Maps – The parcel is now correctly zoned as ALL R2.	1993 Zoning Maps	
	722 Springdale Ave.		20% split w/ R4	All R2
54	020600004939200	An error was made while digitizing documents for the 2005 Zoning Maps – The parcel is now correctly zoned as ALL R2.	1993 Zoning Maps	
	728 Springdale Ave.		20% split w/ R4	All R2
55	020600006094900	An error was made while digitizing documents for the 2005 Zoning Maps – The parcel is now correctly zoned as ALL R2.	1993 Zoning Maps	
	Springdale Ave. p.0206		20% split w/ R4	All R2
56	020600090007688	An error was made while digitizing documents for the 2005 Zoning Maps – The parcel is now correctly zoned as ALL R2.	1993 Zoning Maps	
	790 Parkwood Ave.		20% split w/ R4	All R2